

KL-6600 TOUCH SCREEN WI-FI THERMOSTAT

KL-6600 touch screen fan coil temperature controller with has a unique long-range control function, easy operation, energy saving and environmental protection. With on-site temperature to control the ON/OFF of fan coil unit, so that users can get comfortable environment. Control the air conditioning system by selecting and setting the temperature type, operating mode and required parameters, so as to maintain the ideal temperature of the environment.

1、 Display status :

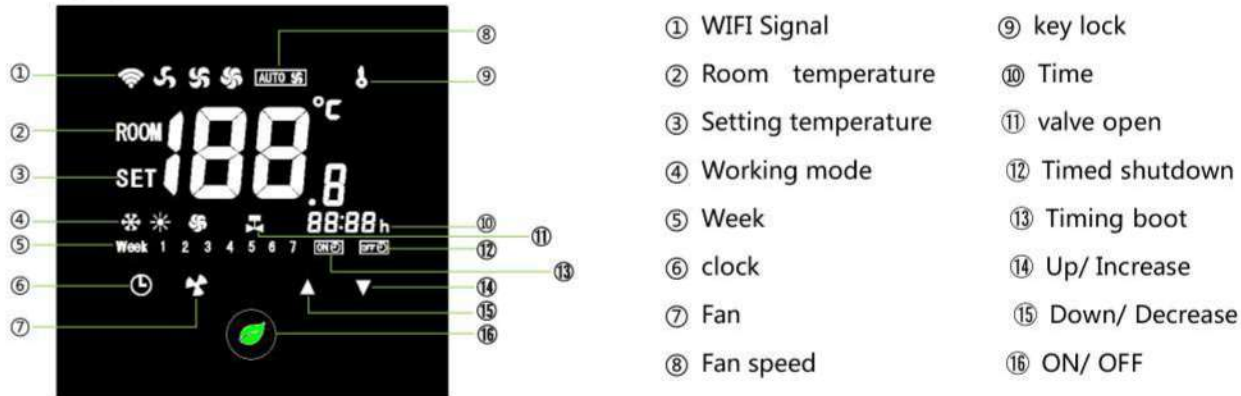

2、 Technical Data :

Sensor : NTC	Powr voltage : 100-260V , 50/60Hz
Accuracy : ±1°C	Load current : I _{max} 5A
Display precision : 0.5°C	Consumption : < 1W
Set-point Range : 5~35°C	On-load Consumption : < 1000W
Display Range : 0~99°C	wiring terminal : can connect the 2*1.5mm ² or 1*2.5mm ² wires
Operation temperature range : 0~45°C	Plastic : PC+ABS(fire resistance)
Display : LCD	Measurement : 86×86×15.8mm (H*W*D)
Humidity : 5~95%RH (Non-condensing)	Hole pitch: 60mm(standard)

3、 Operation :

POWER : Press "☑" for ON/OFF. It will show the room temperature when the power on and stop the display, the fan coil & valve.

Ajustment : Under the power on status, press "🕒" for mode chagement. While the display show "❄️", it menas cool;And "🔥" for heat,, "🌀" for fan.

Fan speed adjustment :Undet the power on status, press "🌀" to choose 4 different fan speeds:High speed "🌀"、Mid-speed "🌀"、 Lowe speed "🌀"、 Auto "AUTO 🌀" (No auto speed under the fan mode).

Temperature setting : Undet the power on status, press "▲" or "▼" to check the current temperature, then press againfortemperature setting, each press will change 0.5°C.

Time setting : Undet the power on status, keep long press "🕒" for 3 seconds until the screen show "00 : 00h " signal , the minute signal flashed, and press "▲" or "▼" to setting the minutes, then press "🕒" , the hour signal flashed and press "▲" or "▼" for setting hours. As the same, then press "🕒" , the week signal flashed, and press "▲" or "▼" for week setting.

Timng boot : Undet the power on status, long press "🕒" for 3 seconds until the screen show "00 : 00h " , short press "🕒"

until show "ON"、"00 :00h " signal , the minutes signal flashed, then press "▲" or "▼" to setting the minutes,and press "⏸" , the hour signal flashed, with press "▲" or "▼" for hour setting, it will keep record in 5 seconds after everything finish setting. So when start the time boot function, it will open the fan coil & valve automatically when reach the setting time under power on status.

Timed shutdown : Under the power on status, long press "⏸" for 3 seconds until the screen show the signal "00 : 00h " , then short press "⏸" until it show "OFF"、"00 : 00h" signal , the minutes sigal flashed, press "▲" or "▼" for minutes setting, then press "⏸" , the time sigal flashed, press "▲" or "▼" for hour setting , it will keep record in 5 seconds after everything finish setting. So when start the time shutdown function, it will close the fan coil & valve automatically when reach the setting time under power on status.

Key lock : Under the power on status, press "▲" & "▼" together for 5 seconds, the screen will show "🔒" ; Under the locked status, press "▲" & "▼" for 5 seconds to unlock it.

4. Parameter Setting :

Under the power off status, press both "⏸" & "🔌" for 3 seconds to come into parameter setting status , the parameters show at the lower right of the screen, press "⏸" to choose the related setting parameters, and the data will show in the middle of the screen, press "▲" or "▼" to adjust the data and it also will be kept record in 5 minutes. Parameters show as below:

SKU	OPTION	Default parameters	Setting range
01	temperature correction	-2	Set range : -9~9°C
02	Start the temperature difference	1	Setting range : 1°C~5°C , e.g : when setting it as 3°C , under the cool mode,the setting temperature is 20°C, so when the room temperature over or reach to 23°C, the fan coil & valve will be open; while decreased to 19°C, it will be closed.
03	Low temperature protection	00	00 : Closed ; 01 : Started , when the room temperature lower than 5°C , the heating unit & valve will be open, and the fan coil will keep in low speed run. When the temperature reached 5°C , it will return to normal operation(power off status also will be available, show as "🔌"、"🔌")。
04	Setting temperature upper limit	35.0°C	Setting range : 5.0~50.0°C
05	Setting temperature minimum level	5.0°C	Setting range : 0~35.0°C (the setting minimum level must be less than the upper limited)
06	Keyboard lock	00	00 : Lock all the rest keys except the power key ; 01 : lock all the key ;
07	Re-start by for power off	00	00 : return to the previous status before power off ; 01 : closed ; 02 : open

08	Cycling run/ Non-cycling run	00	<p>00 : Control fan coil and motorized valve, when the room temperature reach the set-point, it will close the valve and turn off the fan coil unit</p> <p>01 : Control fan coil and motorized valve, when the room temperature reach the set-point, it will close the valve with the fan coil speed still running</p>
----	---------------------------------	----	--

5.WIFI connection & operation



Pic①

1、 Scan the above Pic① QR Code by cellphone or sourcing the Apps “Wisen” or “丛云” at the App store.



Pic②

2、 follow the insturction to install the Pic② App “Wisen” or “丛云”



Pic③

3、 See pic③ , you can choose QQ,Wechat or E-mail address to create a new account.



pic④

4、 See pic④ , add the device



pic⑤

5、 see pic⑤ , connect “WI-FI 配网”

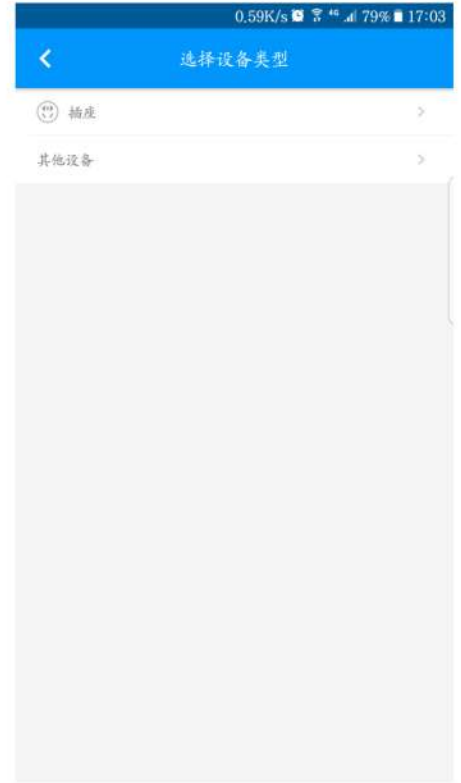

pic⑥

6、 see pic⑥, connect the “其他设备”



pic⑦

7、 see pic⑦ , enter the current cellphone used WIFI password, then long press the thermostat “” key , until it show “” flashed,then press” confirm” for connection.



pic⑧

8、 See pic⑧ , keep waiting the connection successful pic 8、 ,press “finished; Or re-set again to make it connect successful.



Pic⑨

9. See pic⑨ , connect successful and enter the operation interface.

6、 Installation :

Step 1 : cut off all the related control system supply

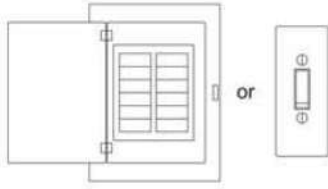

Step2: take off the back iron plate.
(See attachment.)



Step3: Take off the screw and fix the and power iron plate in the wall socket.

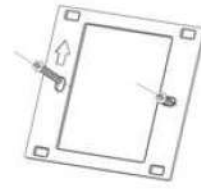

Step4:connect the wire as the wiring diagram

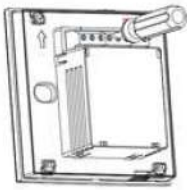

Step 5: Connect the back iron plate & front plate matched well

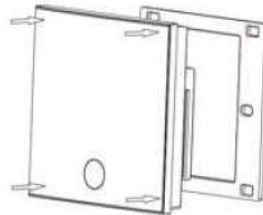

7、 Wiring diagram :

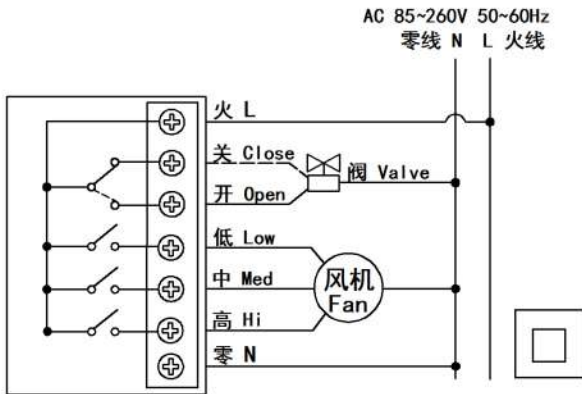

Warning: please ask the professional worker to install them by follow this connecting diagram under no power/ electricity conditions. Please make sure do not put any water, mud and other impurities into the thermostat, otherwise it will cause device damage.